

# 1600 STEELES AVENUE WEST VAUGHAN

Retail Space

# FOR LEASE



Another project by THE MILESTONE GROUP  
Developers and Owners of Quality Real Estate



For more information, please contact:

**416.636.8898**

**Matthew Brown (x223)**

Director, Sales & Leasing  
Sales Representative  
[mbrown@thebehargroup.com](mailto:mbrown@thebehargroup.com)

**Barbara Kless (x240)**

Vice President, Retail Leasing  
Sales Representative  
[bkless@thebehargroup.com](mailto:bkless@thebehargroup.com)

**Greg Evans (x230)**

President, Broker of Record  
[gevans@thebehargroup.com](mailto:gevans@thebehargroup.com)

- Located just west of Dufferin Street on the north side of Steeles Avenue West
- Large draw power centre across the road (Real Canadian Superstore, Home Depot)
- Beautifully maintained, established project with 63,721 square feet of fully occupied office space and 87,379 square feet of retail space
- Highest profile "landmark" mixed-use development in the area
- T.T.C. at the door, minutes to Allen Road / Hwys. 401 & 407 / Yorkdale Shopping Centre
- Traffic counts: 46,000 cars daily on Steeles Avenue West (estimate)
- Pylon signage available
- Tenants include: Tim Hortons, The Avenue Banquets, Medical, and Dental
- Ideal for service oriented retail

The Behar Group Realty Inc., Brokerage  
1170 Sheppard Avenue West, Unit 24, Toronto, Ontario M3K 2A3 / Tel: 416.636.8898 / Fax: 416.636.8890 / Website: [www.thebehargroup.com](http://www.thebehargroup.com)

All information is from sources deemed reliable and is subject to errors and omissions which we believe to be correct and assume no responsibility. Changes of price, rental, prior sale and withdrawal without notice. People are not to construe this information as legal or tax advice. You should consult your legal counsel, accountant, or other advisors on matters relating to this presentation. The Behar Group Realty Inc., Brokerage.

# 1600 STEELES AVENUE WEST VAUGHAN Retail Space

# FOR LEASE

 Available

## Tenants include:

- Medical
- Dental
- The Avenue Banquets
- Tim Hortons
- Adecco

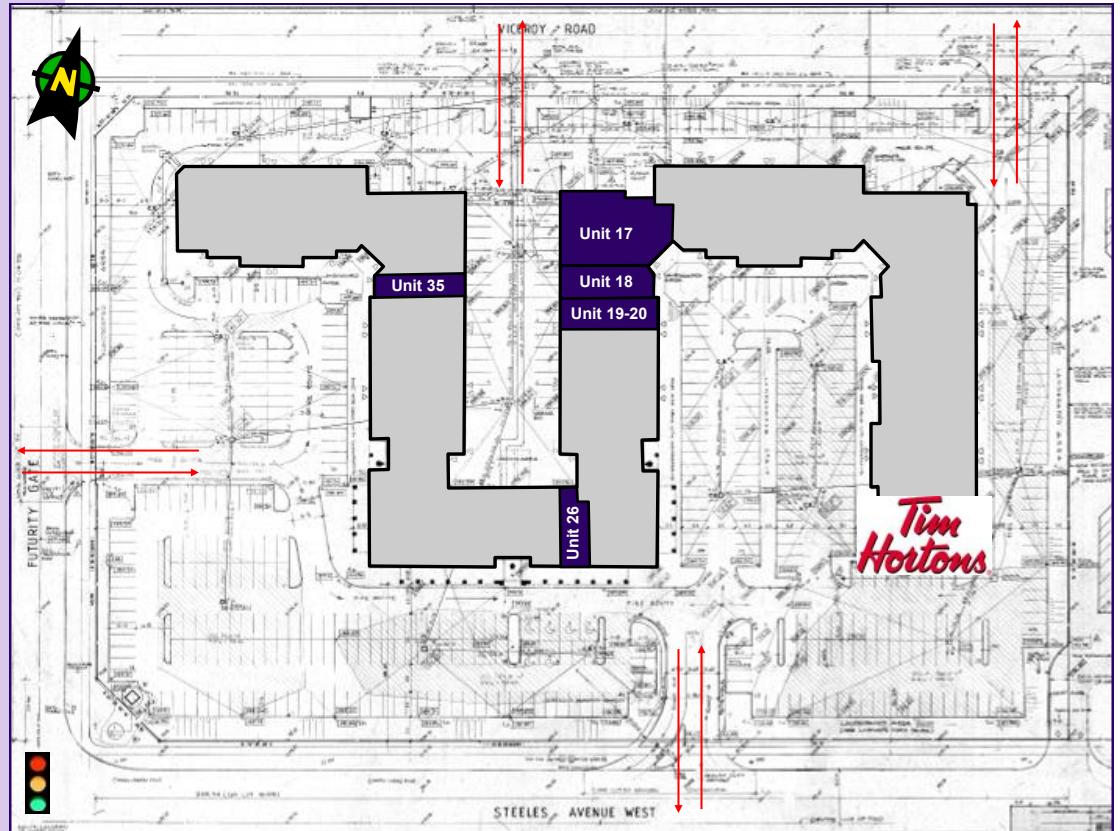

THE BEHAR GROUP

For more information, please contact:

**416.636.8898**

### Matthew Brown (x223)

Director, Sales & Leasing  
Sales Representative  
[mbrown@thebehargroup.com](mailto:mbrown@thebehargroup.com)

### Barbara Kless (x240)

Vice President, Retail Leasing  
Sales Representative  
[bkless@thebehargroup.com](mailto:bkless@thebehargroup.com)

### Greg Evans (x230)

President, Broker of Record  
[gevans@thebehargroup.com](mailto:gevans@thebehargroup.com)

CURRENT OPPORTUNITIES				
Unit #	Size (SF)	Net Rent	TMI (2020)	Possession
17	4,534	\$20.00	\$6.35	Immediate
18*	1,776	\$23.00	\$6.50	Immediate
19-20*	3,850	\$23.00	\$6.50	Immediate
26	1,610	\$25.00	\$10.50	Immediate
35	1,850	\$23.00	\$7.30	Immediate

\* Units 18 & 19-20 can be combined for a total of 5,626 SF



# 1600 STEELES AVENUE WEST VAUGHAN Retail Space

# FOR LEASE



For more information, please contact:

**416.636.8898**

**Matthew Brown (x223)**

Director, Sales & Leasing  
Sales Representative  
[mbrown@thebehargroup.com](mailto:mbrown@thebehargroup.com)

**Barbara Kless (x240)**

Vice President, Retail Leasing  
Sales Representative  
[bkless@thebehargroup.com](mailto:bkless@thebehargroup.com)

**Greg Evans (x230)**

President, Broker of Record  
[gevans@thebehargroup.com](mailto:gevans@thebehargroup.com)

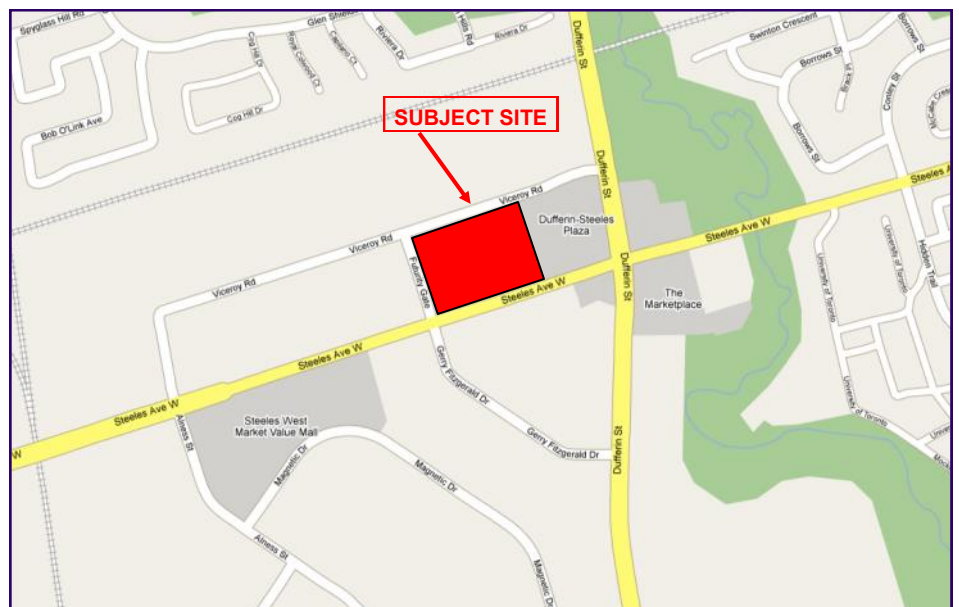

The Behar Group Realty Inc., Brokerage  
1170 Sheppard Avenue West, Unit 24, Toronto, Ontario M3K 2A3 / Tel: 416.636.8898 / Fax: 416.636.8890 / Website: [www.thebehargroup.com](http://www.thebehargroup.com)

All information is from sources deemed reliable and is subject to errors and omissions which we believe to be correct and assume no responsibility. Changes of price, rental, prior sale and withdrawal without notice. People are not to construe this information as legal or tax advice. You should consult your legal counsel, accountant, or other advisors on matters relating to this presentation. The Behar Group Realty Inc., Brokerage.