

TAUNTON RD. E. & SEBASTIAN ST., WHITBY

PRIME RETAIL AND OFFICE SPACE FOR LEASE

TAUNTON ROAD EAST

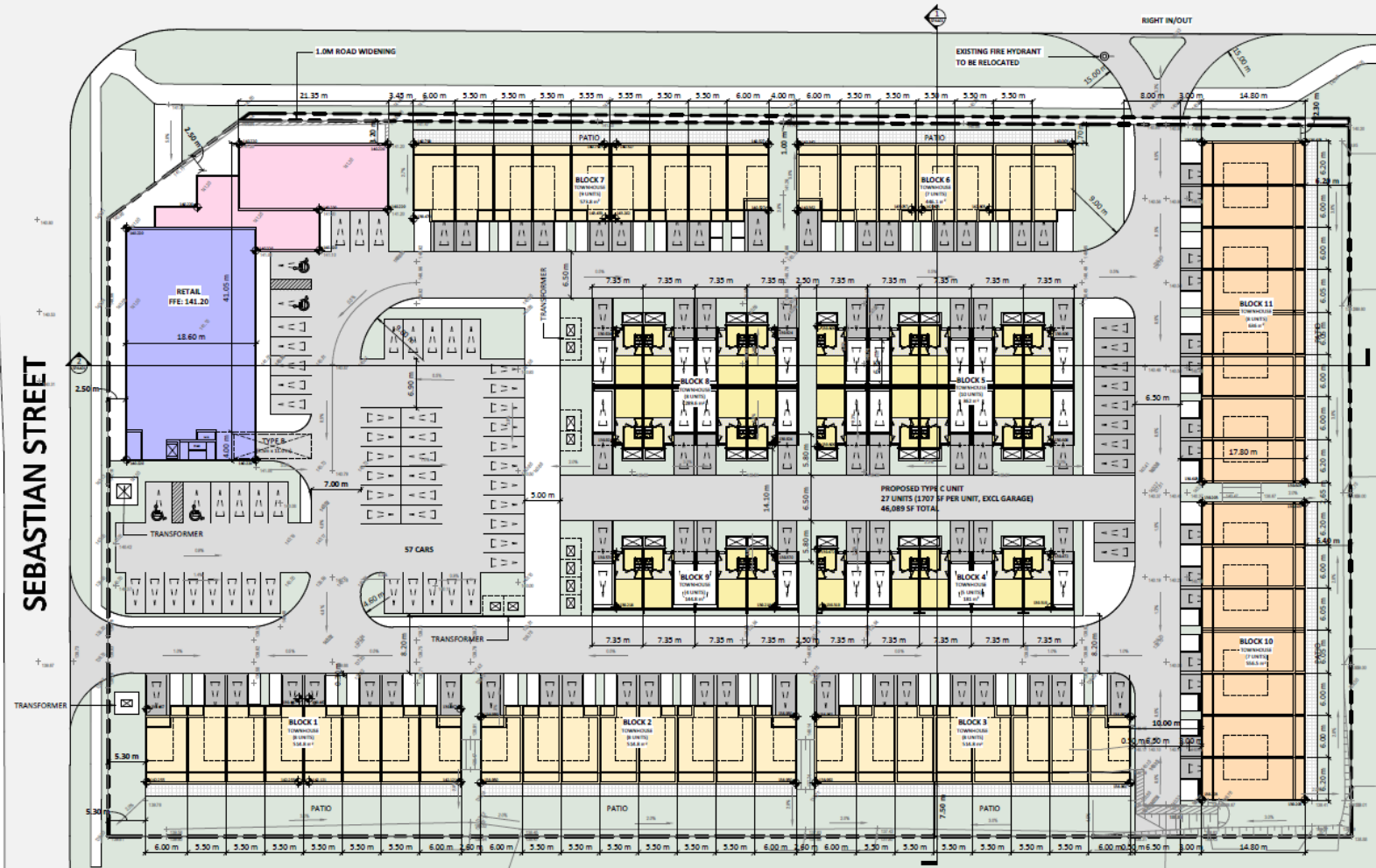

Site Plan Draft—Not yet approved—Subject to Change

9,528 sq ft (ground) and 6,966 sq ft (second level)

Located at the southeast corner of Taunton Rd. E. and Sebastian St.

INQUIRIES

Rami Kozman
Director, Landlord Services
Sales Representative
416 636 8898 x245
rkozman@thebehargroup.com

Greg Evans
President
Broker of Record
416 636 8898 x2230
gevans@thebehargroup.com



TAUNTON RD. E. & SEBASTIAN ST., WHITBY

PRIME RETAIL AND OFFICE SPACE FOR LEASE

DETAILS

- Prime retail and office leasing opportunity
- Located at the southeast corner of Taunton Road East and Sebastian Street
- Plentiful surface parking
- Ideal for retail, restaurant, professional service, medical and daycare
- Area: 9,528 sq. ft. (ground) and 6,966 sq. ft. (second level)
- Rents: TBD
- Possession: Estimated late 2021

Demographics	1 km	3 km	5 km
Total Population (2016)	5,146	41,487	138,073
Daytime Population (2015)	1,765	15,521	70,704
Total Households (2016)	1,623	13,649	50,506
Household Average Income (2016)	\$130,624	\$126,186	\$104,874

Source: Statistics Canada



All information is from sources deemed reliable and is subject to errors and omissions which we believe to be correct and assume no responsibility. Changes of price, rental, prior sale and withdrawal without notice. People are not to construe this information as legal or tax advice. You should consult your legal counsel, accountant, or other advisors on matters relating to this presentation. The Behar Group Realty Inc., Brokerage.

