

TAUNTON RD. E. & WILSON RD. N. OSHAWA

Proposed Prime Retail Development Site

FOR LEASE

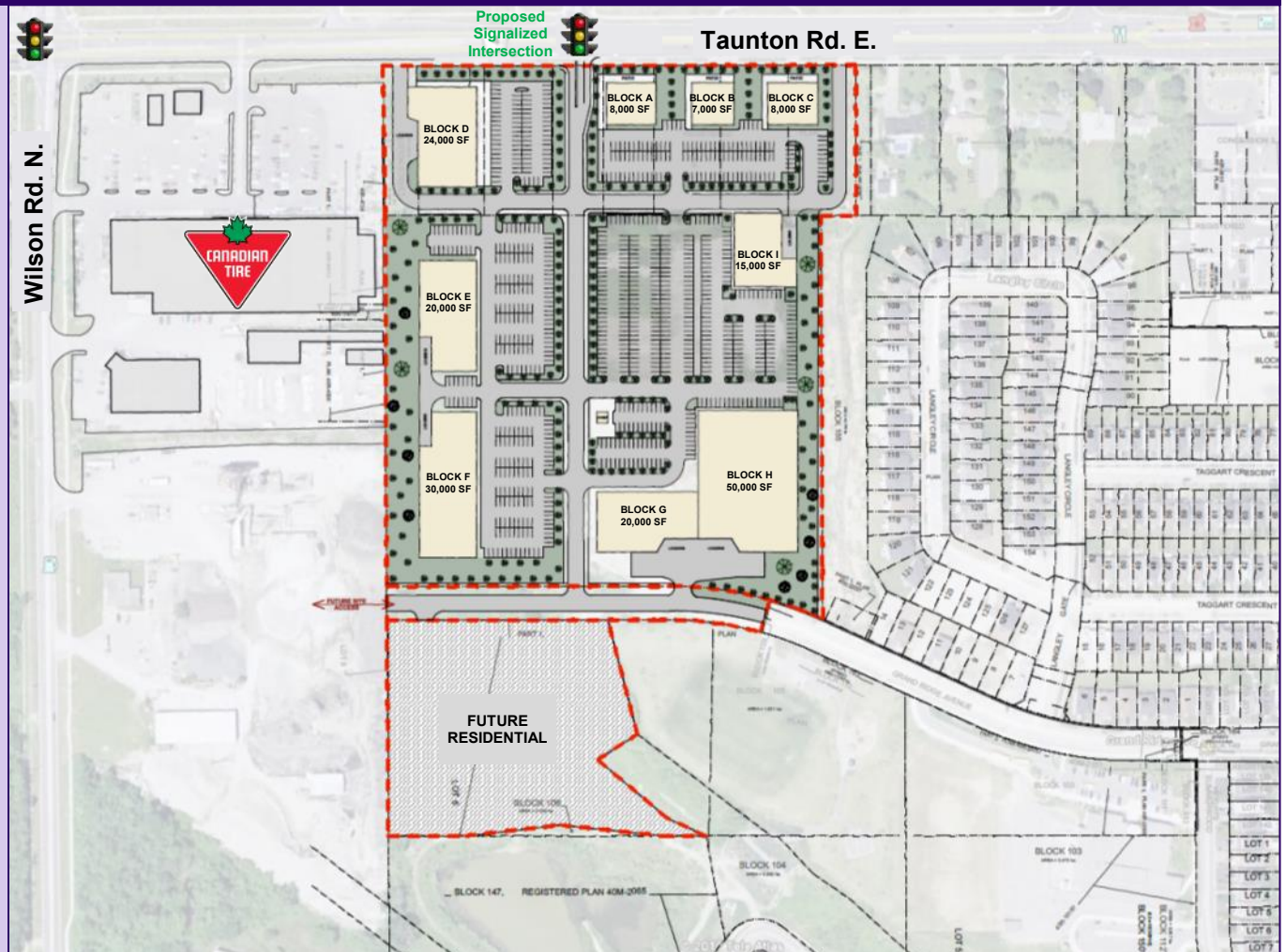

For more information, please contact:

416.636.8898

Avi Behar (x227)

CEO, Broker

abehar@thebehargroup.com

- Proposed prime retail development site
- Up to 300,000 square feet available
- Proposed signalized intersection directly into the site
- Proposed large frontage on Taunton Road
- Directly across from Sobeys and adjacent to Canadian Tire
- High growth area with more residential planned
- Numerous national and international retailers in this node
- Rents & Timing: TBD

The Behar Group Realty Inc., Brokerage
1170 Sheppard Avenue West, Unit 24, Toronto, Ontario M3K 2A3 / Tel: 416.636.8898 / Fax: 416.636.8890 / Website: www.thebehargroup.com

All information is from sources deemed reliable and is subject to errors and omissions which we believe to be correct and assume no responsibility. Changes of price, rental, prior sale and withdrawal without notice. People are not to construe this information as legal or tax advice. You should consult your legal counsel, accountant, or other advisors on matters relating to this presentation. The Behar Group Realty Inc., Brokerage.

TAUNTON RD. E. & WILSON RD. N. OSHAWA

Proposed Prime Retail Development Site

FOR LEASE



For more information, please contact:

416.636.8898

Avi Behar (x227)

CEO, Broker

abehar@thebehargroup.com

Demographics - 2012 Year	1 km	3 km	5 km
Total Population	10,026	62,399	111,395
Daytime Population	6,263	36,964	89,497
Total Households	3,556	22,575	42,050
Household Average Income	\$80,927	\$88,315	\$84,500

Demographic data provided by [Generation5 Inc.](http://www.generation5.com) © 2013