

# 1323 KING STREET EAST OSHAWA Retail / Commercial Space

## FOR LEASE

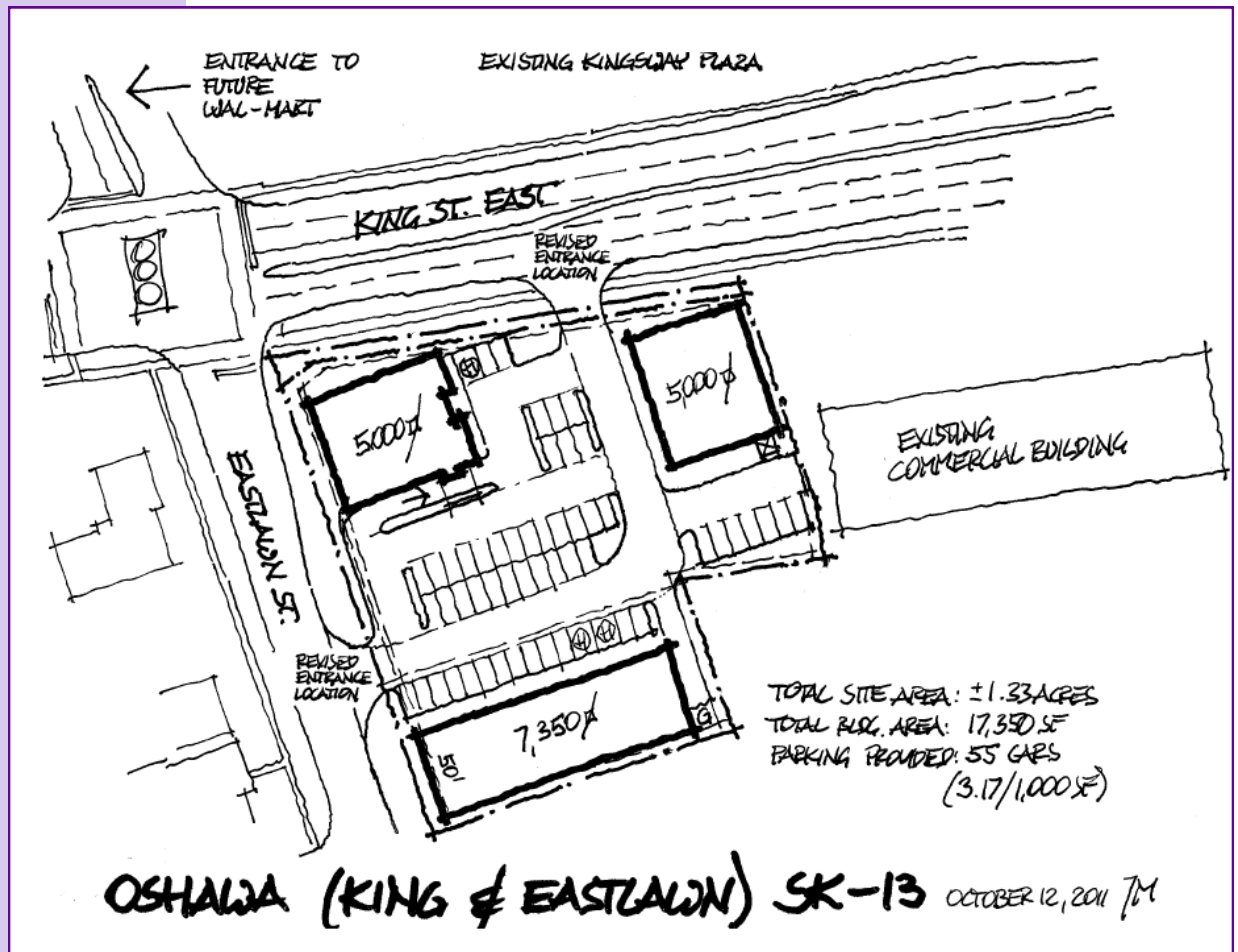

For more information, please contact:

**Sari Samarah**  
Sales Representative  
**416.636.8898 ext. 231**  
**416.636.8890 fax**  
[sari@thebehargroup.com](mailto:sari@thebehargroup.com)

- Located on the southwest corner of King Street East and Eastlawn Street
- Retail development across from No Frills, Shoppers Drug Mart and Zellers (turning into Walmart in Summer 2012)
- Landlord will build to suit
- Pads or inline units available
- Retail, restaurant and or gas uses permitted
- Possession: Fall 2012
- Rents: TBD

# 1323 KING STREET EAST OSHAWA Retail / Commercial Space

# FOR LEASE

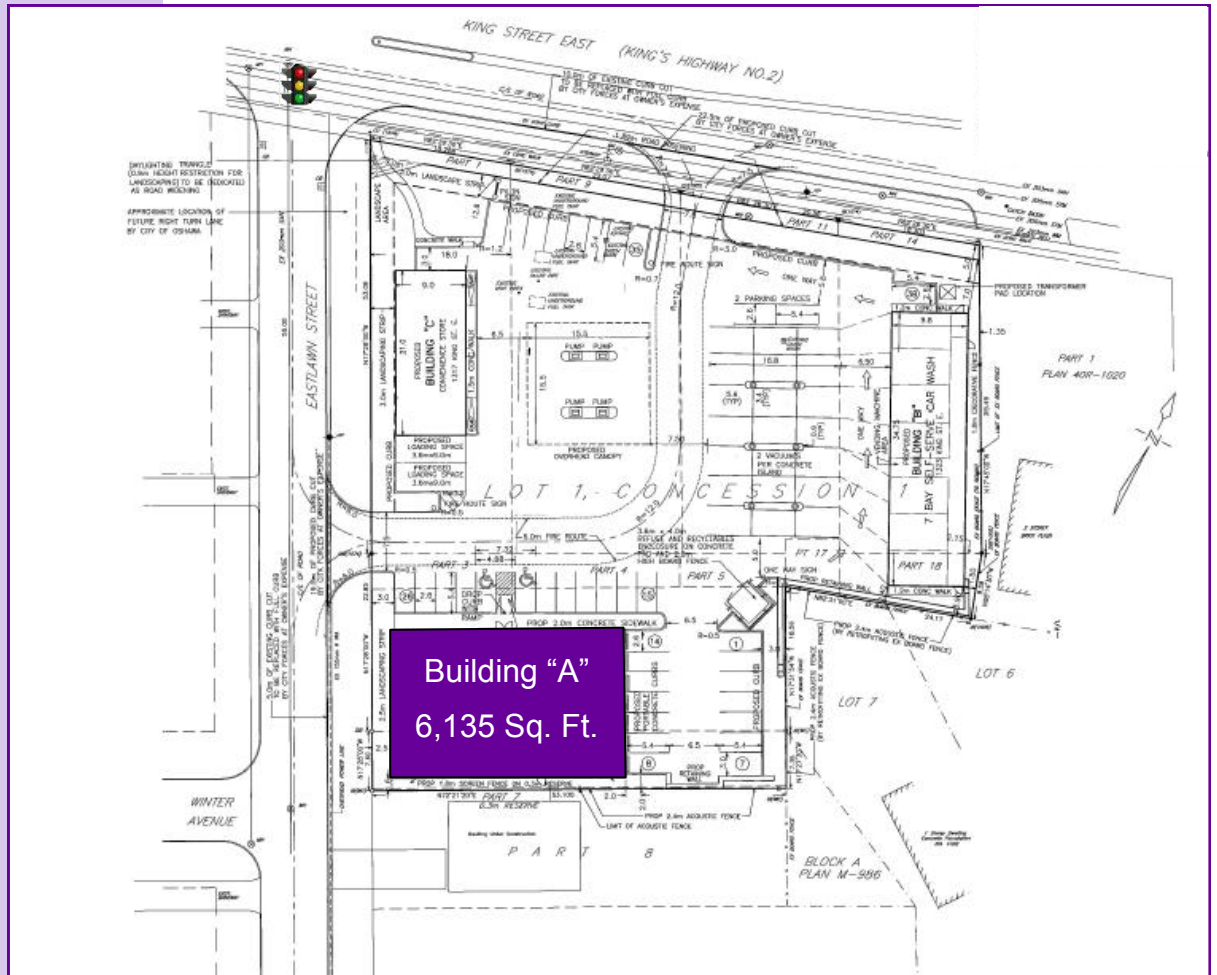

For more information, please contact:

**Sari Samarah**  
Sales Representative  
**416.636.8898 ext. 231**  
**416.636.8890 fax**  
[sari@thebehargroup.com](mailto:sari@thebehargroup.com)

