

**NEW DEVELOPMENT  
ONLY PLAZA IN AREA!**



[Click here to enlarge panorama](#)

Note: ability to view and scroll image is dependent on your image viewing application

## **SOUTHWEST CORNER OF GEORGE REYNOLD DRIVE AND TRULLS ROAD, COURTICE**



Please contact:

**GREG EVANS**  
Broker  
Vice President  
O: (416) 636-8898 ext. 230  
M: (416) 722-5187  
[gevans@thebehargroup.com](mailto:gevans@thebehargroup.com)

OR

**CHRISTOPHER SEEPE**  
Sales Representative  
Director of R&D  
M: (416) 525-1558  
O: (416) 636-8898 ext. 224  
[cseepe@thebehargroup.com](mailto:cseepe@thebehargroup.com)

- ◆ New retail plaza development (zoning, p.2)
- ◆ No other retailers within 10-minutes' walking distance
- ◆ Surrounded by middle class residential (demographics, p.3)
- ◆ Total 5,380 square feet, will demise (site plan, p.4)
- ◆ Playground at back, landscaped front, 22 parking
- ◆ Developer can build to suit retailer specifications
- ◆ Possession: TBD      Net & Additional Rent: TBD



Please contact:

**GREG EVANS**

Broker  
 Vice President  
 O: (416) 636-8898 ext. 230  
 M: (416) 722-5187  
[gevans@thebehargroup.com](mailto:gevans@thebehargroup.com)

OR

**CHRISTOPHER SEEPE**

Sales Representative  
 Director of R&D  
 M: (416) 525-1558  
 O: (416) 636-8898 ext. 224  
[cseepe@thebehargroup.com](mailto:cseepe@thebehargroup.com)

## Zoned: C2-2

Neighbourhood Commercial Exception Zone

- ✦ Day nursery
- ✦ Medical or dental clinic
- ✦ Convenience store
- ✦ Dry cleaners distribution centre
- ✦ Business, professional or administration office
- ✦ Laundry; coin-operated
- ✦ Private club
- ✦ Service shop; personal
- ✦ Retail commercial establishment



The Behar Group Realty Inc., Brokerage  
 1170 Sheppard Avenue West, Unit 24, Toronto, Ontario M3K 2A3 / Tel: 416.636.8898 / Fax: 416.636.8890 / Website: [www.thebehargroup.com](http://www.thebehargroup.com)

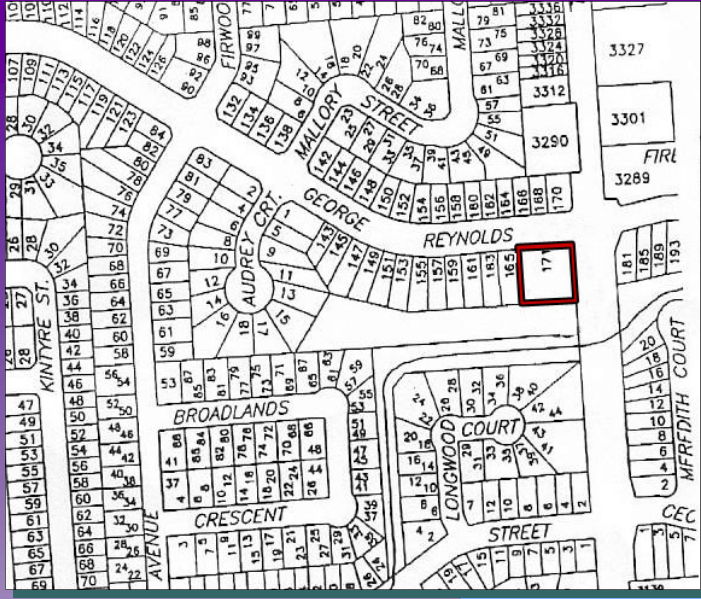

## Demographics (source: Teranet Geowarehouse)

- \* Between Mar. 31/09 & Jan. 15/10, 47 homes sold between \$170,000 (226 m<sup>2</sup>) and \$334,500 (384 m<sup>2</sup>)
- \* \$343 to \$960 per square meter
- \* Dominant Group: affluent families
- \* FSA (area) Population: 24,148
- \* FSA (area) No. of Homes: 7,849
- \* Gender Mix: 49.2% male, 50.8% female

- \* Married (49.2%), Single (31.2%), Sep/Divorced (14.8%)
- \* Age Distribution:
 

30-44	22.2%	10-14	09.9%
00-09	14.8%	15-19	08.6%
20-29	14.8%	75+	07.5%
45-54	14.8%	55-64	07.4%

- \* House type: single detached (79%)
- \* Avg No. rooms/house: 7.64, avg. bedrooms 3.19
- \* Avg Home Age: 11-25 (58%), <=10 (32%)
- \* FSA Average Household Income: \$94,106
- \* Gray Collar (54%), White Collar (25%), Blue Collar (21%)
- \* Culture Dominance:

Please contact:

**GREG EVANS**  
Broker  
Vice President  
O: (416) 636-8898 ext. 230  
M: (416) 722-5187  
[gevans@thebehargroup.com](mailto:gevans@thebehargroup.com)

OR

**CHRISTOPHER SEEPE**  
Sales Representative  
Director of R&D  
M: (416) 525-1558  
O: (416) 636-8898 ext. 224  
[cseepe@thebehargroup.com](mailto:cseepe@thebehargroup.com)

Rank	Languages	Ethnicity	Religion
1	English 98%	Canadian 25%	Roman Catholic 34%
2	French 1%	English 19%	United Church 18%
3	Polish 1%	Scottish 10%	No Religion 18%
4	n/a	Irish 9%	Anglican 9%
5	n/a	French 4%	Protestant, n.i.e. 3%

All information is from sources deemed reliable and is subject to errors and omissions which we believe to be correct and assume no responsibility. Changes of price, rental, prior sale and withdrawal without notice. People are not to construe this information as legal or tax advice. You should consult your legal counsel, accountant, or other advisors on matters relating to this presentation. The Behar Group Realty Inc., Brokerage.

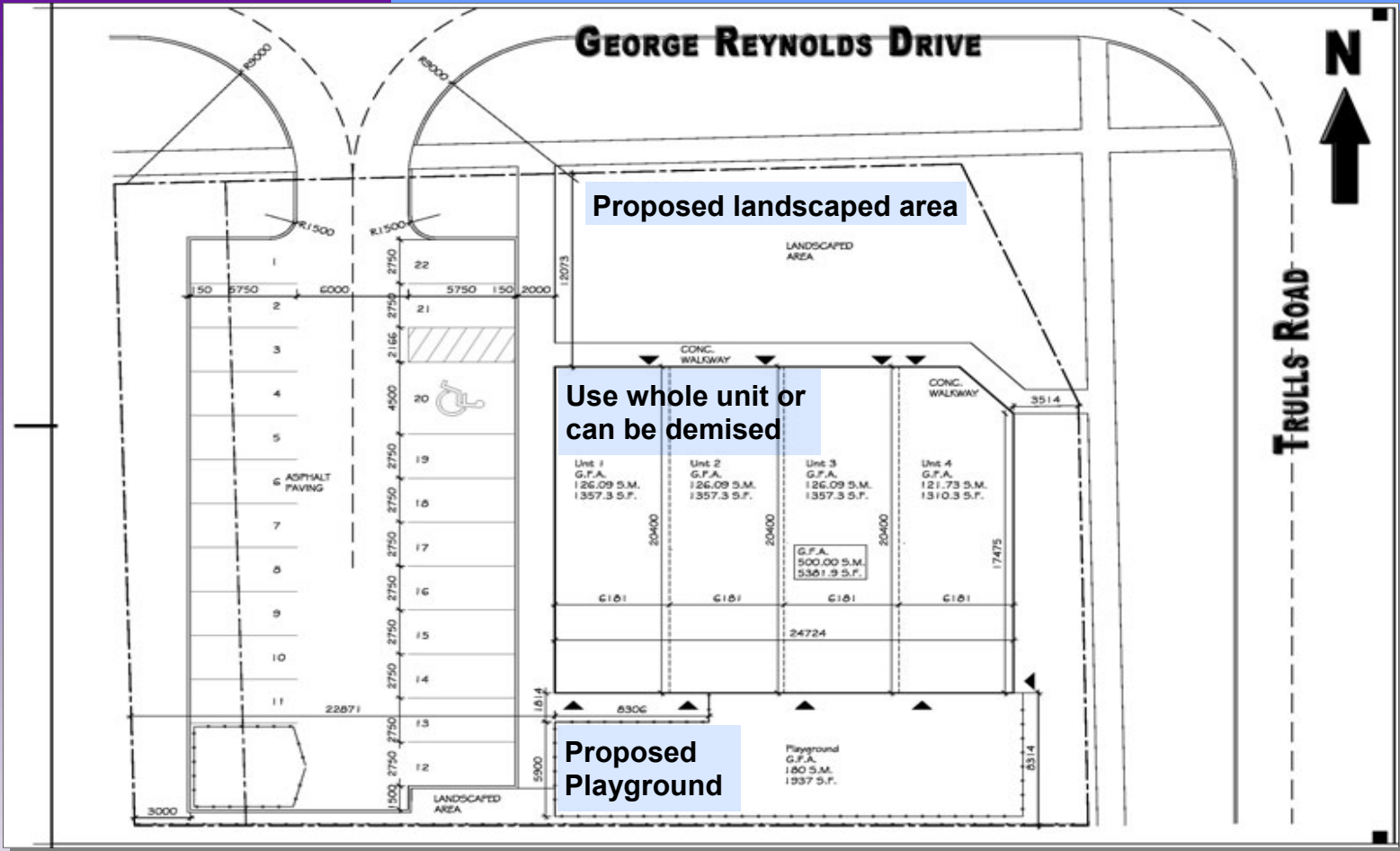

[Click here to enlarge draft site plan](#)

Please contact:

**GREG EVANS**

Broker  
Vice President  
O: (416) 636-8898 ext. 230  
M: (416) 722-5187  
[gevans@thebehargroup.com](mailto:gevans@thebehargroup.com)

OR

**CHRISTOPHER SEEPE**

Sales Representative  
Director of R&D  
M: (416) 525-1558  
O: (416) 636-8898 ext. 224  
[cseepe@thebehargroup.com](mailto:cseepe@thebehargroup.com)

