

3687 NASHUA DRIVE MISSISSAUGA

Commercial / Retail / Restaurant Opportunities

FOR LEASE

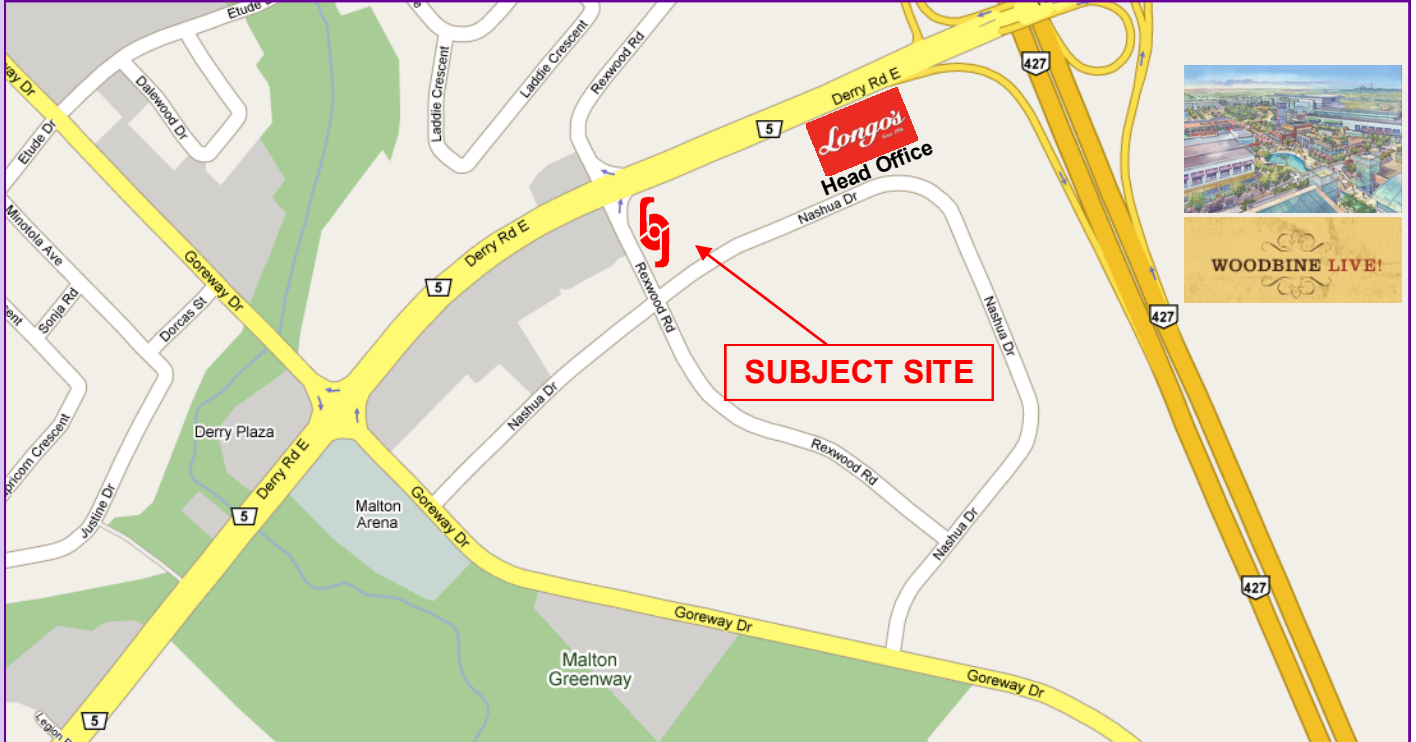

For more information, please contact:

Avi Behar

CEO, Broker

416.636.8898 ext. 227

416.636.8890 fax

abehar@thebehargroup.com

Sari Samarah

Sales Representative

416.636.8898 ext. 231

416.636.8890 fax

sari@thebehargroup.com

- Located in a densely populated industrial and residential node in northeast Mississauga
- Traffic counts: Approximately 50,000 cars daily
- Units available:
 - 1,650 square feet
 - 2,409 square feet
 - 1,417 square feetCan be combined
- 1,530 square feet (Former restaurant)
- Possession: Pad: Spring 2010
- Building: Immediate
- Net Rent: Pad: \$32.00 per square foot
- Building: \$26.00 per square foot
- TMI: \$7.00 per square foot (estimate)

3687 NASHUA DRIVE MISSISSAUGA

Commercial / Retail / Restaurant Opportunities

FOR LEASE

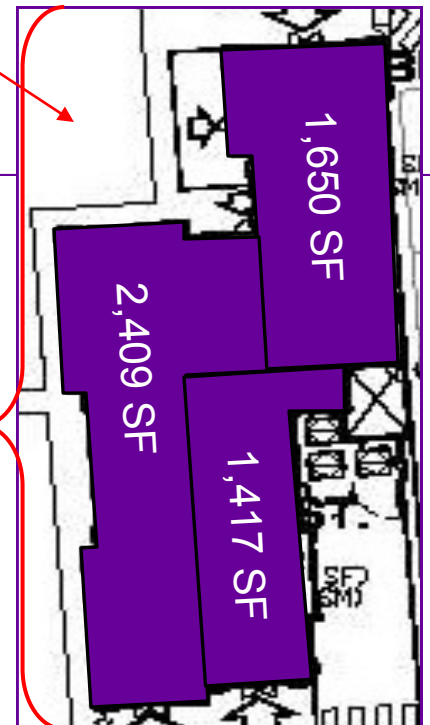
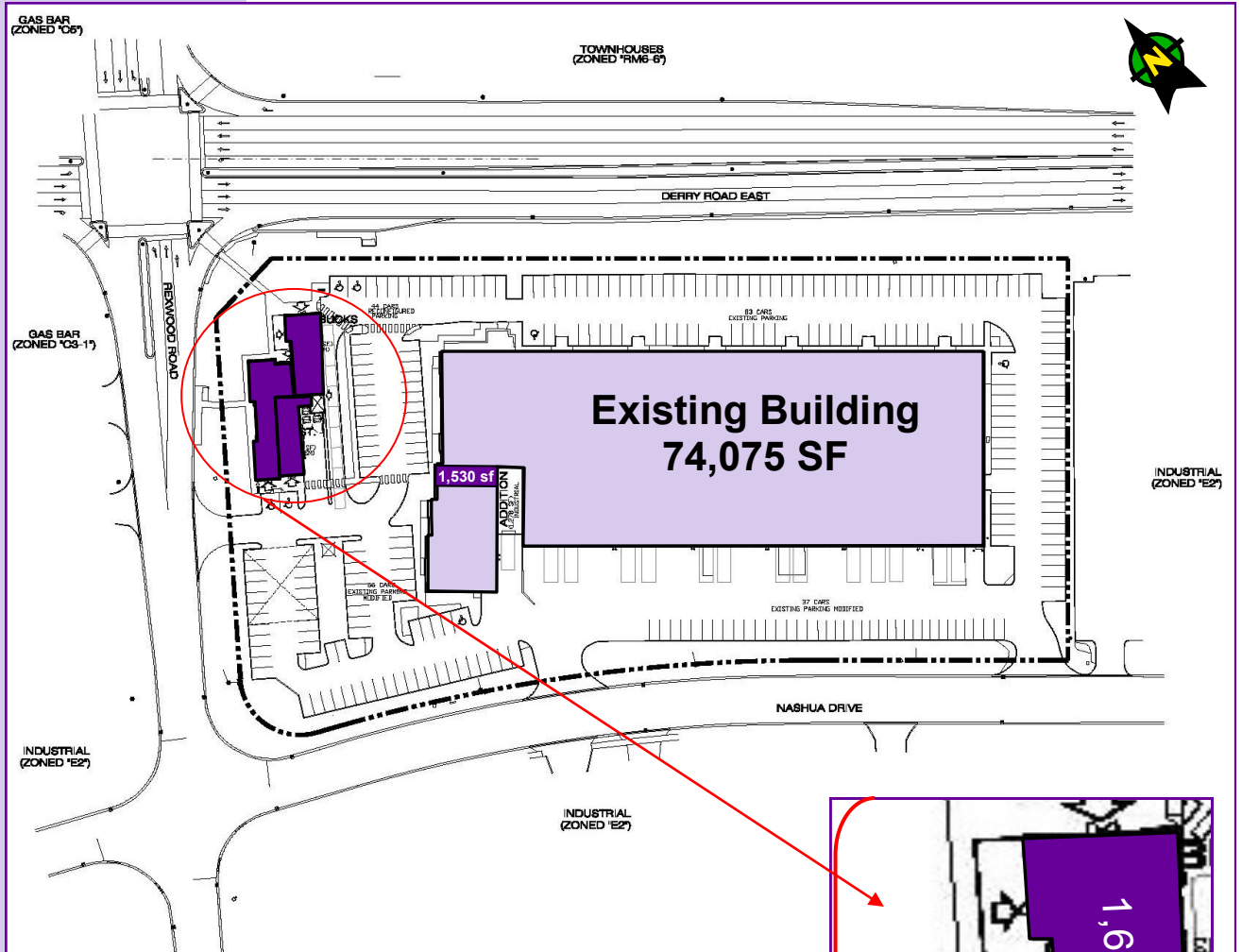

-  Available
-  Leased

For more information, please contact:

Avi Behar

CEO, Broker

416.636.8898 ext. 227

416.636.8890 fax

abehar@thebehargroup.com

Sari Samarah

Sales Representative

416.636.8898 ext. 231

416.636.8890 fax

sari@thebehargroup.com



The Behar Group Realty Inc., Brokerage

1170 Sheppard Avenue West, Unit 24, Toronto, Ontario M3K 2A3 / Tel: 416.636.8898 / Fax: 416.636.8890 / Website: www.thebehargroup.com

All information is from sources deemed reliable and is subject to errors and omissions which we believe to be correct and assume no responsibility. Changes of price, rental, prior sale and withdrawal without notice. People are not to construe this information as legal or tax advice. You should consult your legal counsel, accountant, or other advisors on matters relating to this presentation. The Behar Group Realty Inc., Brokerage.